



OFFICE PROPERTIES



Office Space for Lease



1511 & 1515 Shopton Rd. Charlotte NC 28217

- Suite 104 - 4,218/SF
 - Suite 102 - 2,135/SF
 - Suite H - 1,411/SF
 - Suite F - 1,447/SF
 - Suite C - 1,215/SF
- Located directly off I-77 and Arrowood Rd.
 - \$15.50 Per Square Foot Net of Janitorial
 - Beautifully up-fitted with new carpet and new paint
 - Surface lot parking
 - Please inquire about build to suit purchase options



Data presented on this flyer is secured from reliable sources and while every effort is made to obtain accuracy, it is not guaranteed as errors and omissions may occur.

Randall Bozard – Office Properties -randall@charlotteofficespace.com 704-335-5626

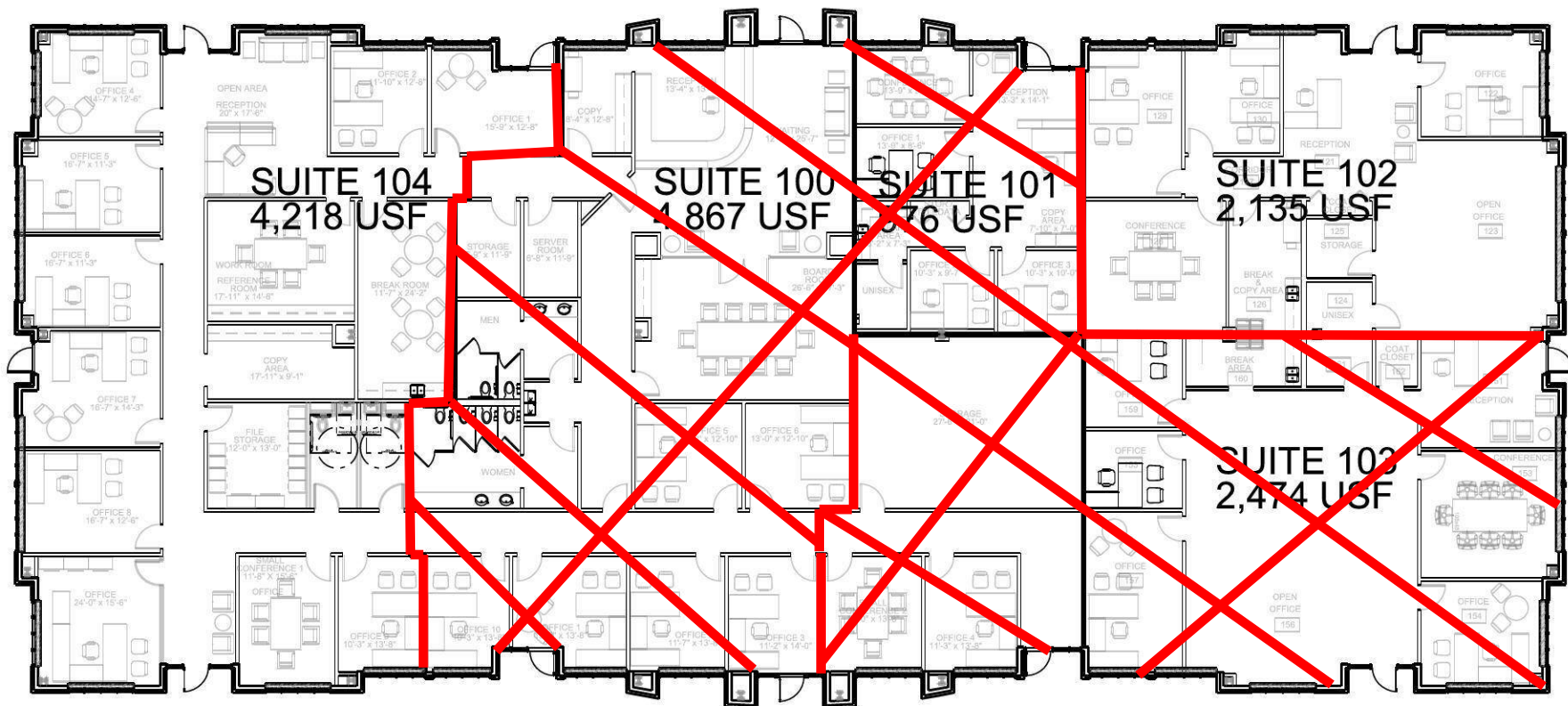

1515 SHOPTON ROAD
NOT TO SCALE

FURNITURE SHOWN FOR ILLUSTRATIVE PURPOSES ONLY

ai DESIGN GROUP
ARCHITECTURE / INTERIORS
500 South College St. Phone(704) 731-8080
Suite 200 Fax (704) 731-8090
Charlotte, NC 28202 www.aidginc.com

REFERENCE:
 PROJ. NO.: 11100
 DATE: 08/22/11
 DRAWN BY.: EH
 CHECKED BY:
 F:\TSPC Partners\leasing requests\tspc1\building1.dgn

1515 SHOPTON ROAD

SHEET TITLE: TENANT SUITES	
PROJECT NAME: TSPC BUILDING 1515	
DO NOT SCALE DRAWINGS. VERIFY DIMENSIONS PRIOR TO CONSTRUCTION. REPORT ERRORS AND OMISSIONS TO THE ARCHITECT IMMEDIATELY.	SUPPLEMENTAL DRAWING NO.: LP-1515

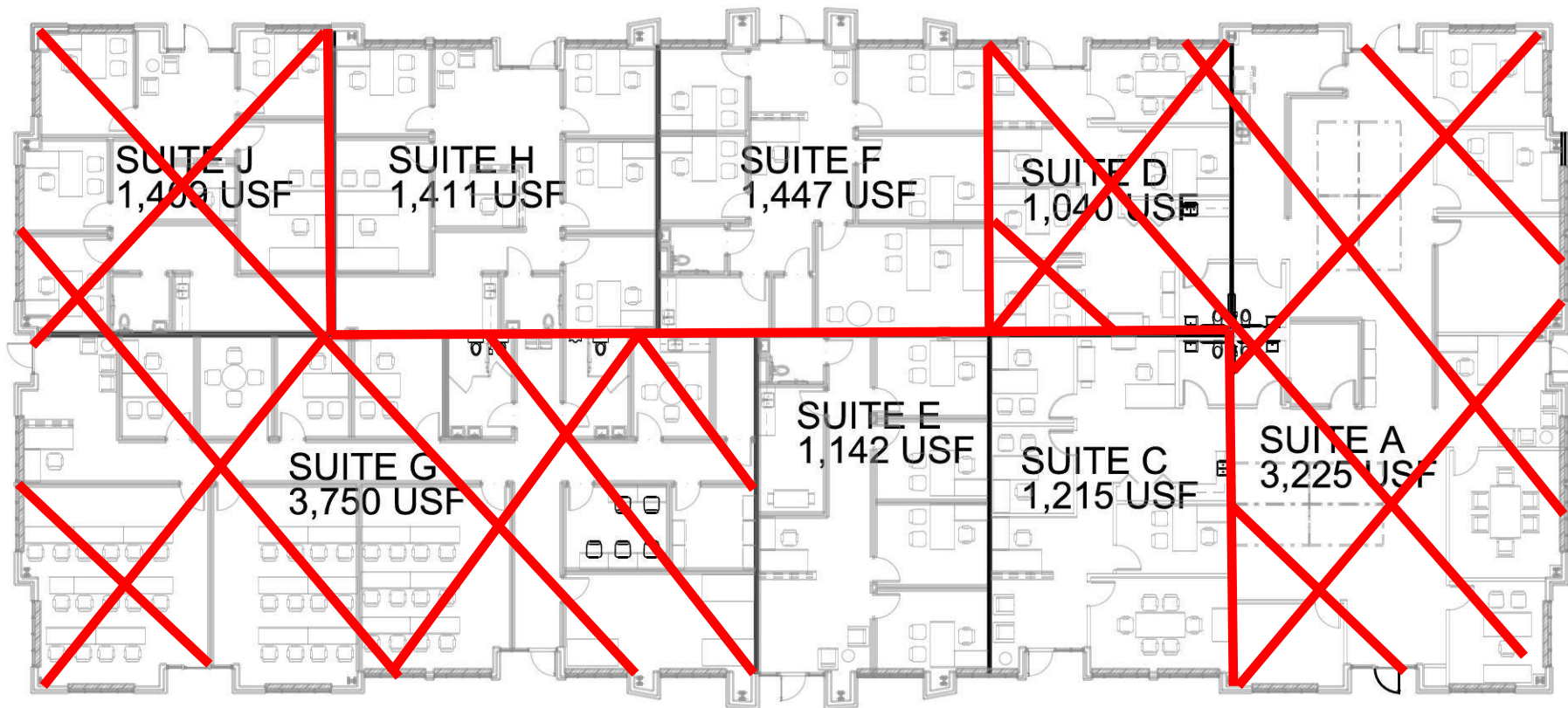

1511 SHOPTON ROAD
NOT TO SCALE

FURNITURE SHOWN FOR ILLUSTRATIVE PURPOSES ONLY

ai DESIGN GROUP
ARCHITECTURE / INTERIORS
500 South College St. Phone(704) 731-8080
Suite 200 Fax (704) 731-8090
Charlotte, NC 28202 www.aidginc.com

REFERENCE:
 PROJ. NO.: 11523
 DATE: 10/13/11
 DRAWN BY.: EH
 CHECKED BY:
 F:\TSPC Partners\11523 Prospect_1511\0active\building2b.dgn

1511 SHOPTON ROAD

SHEET TITLE: TENANT SUITES
 PROJECT NAME: TSPC BUILDING 1511
 DO NOT SCALE DRAWINGS. VERIFY DIMENSIONS
 PRIOR TO CONSTRUCTION. REPORT ERRORS
 AND OMISSIONS TO THE ARCHITECT IMMEDIATELY.
 SUPPLEMENTAL
 DRAWING NO.: LP-1511